

HIGHLAND AVENUE (R.O.W. 60' WIDE)

RESIDENTIAL PROPERTIES

PARKER BOULEVARD (R.O.W. 80' WIDE)

PARKHURST BOULEVARD (28.2' WIDE)

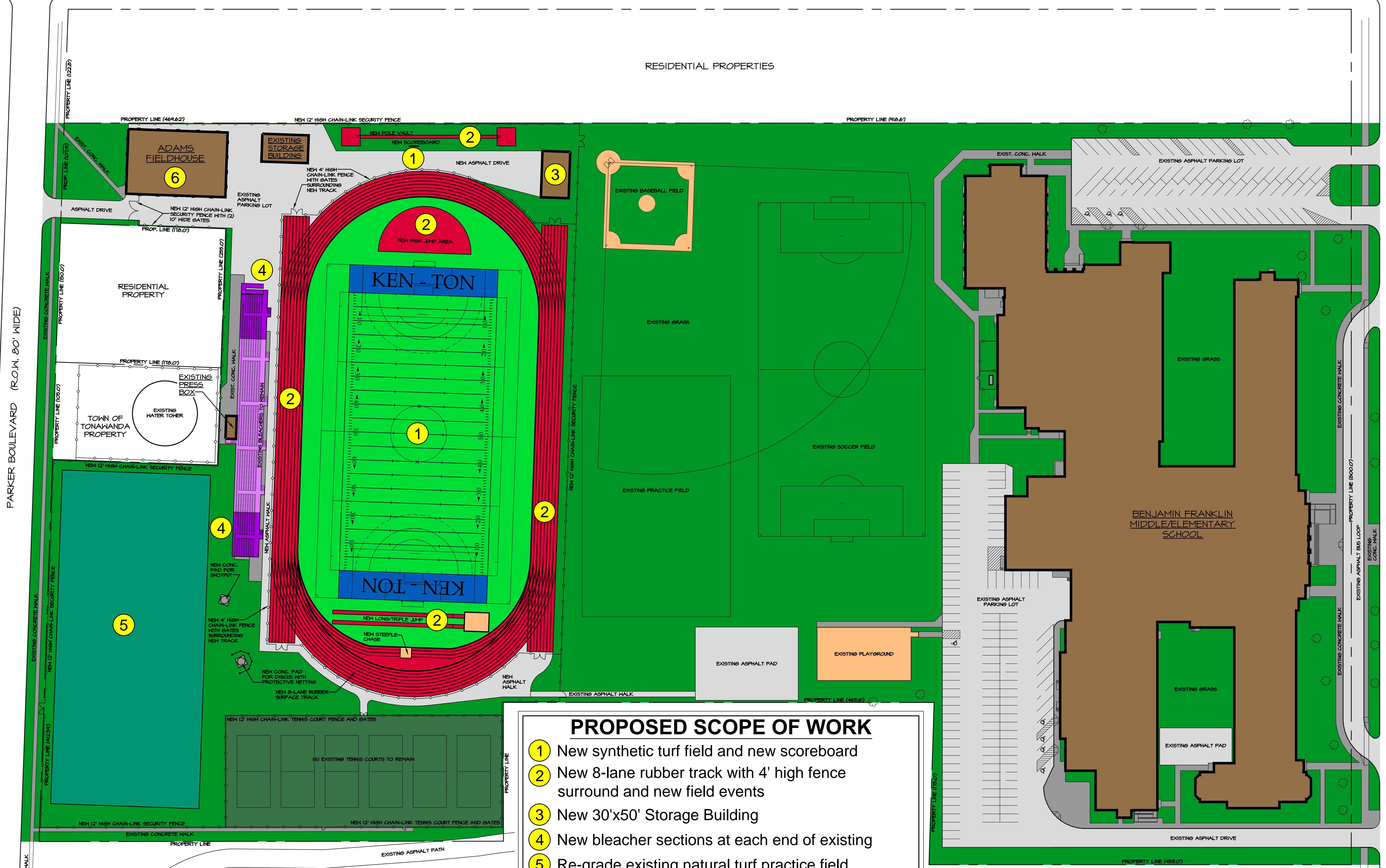

- PROPOSED SCOPE OF WORK**
- 1 New synthetic turf field and new scoreboard
  - 2 New 8-lane rubber track with 4' high fence surround and new field events
  - 3 New 30'x50' Storage Building
  - 4 New bleacher sections at each end of existing
  - 5 Re-grade existing natural turf practice field
  - 6 Adams Field House - Renovate for ADA Accessibility

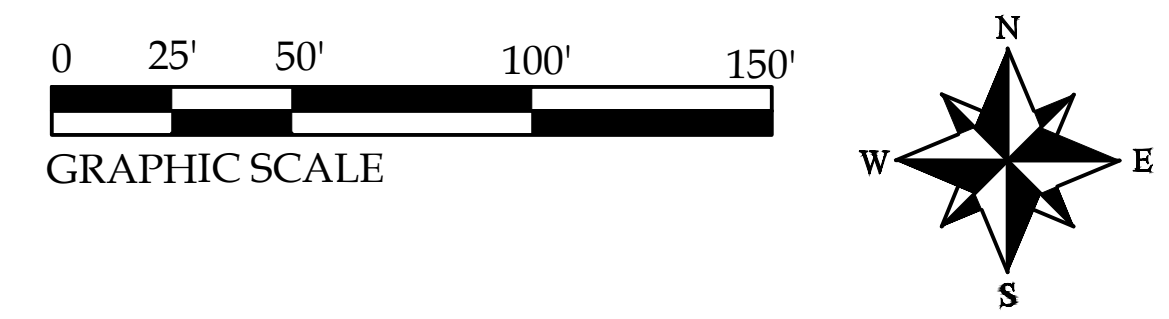

ADAMS FIELD OVERALL SITE PLAN

# KENMORE - TOWN OF TONAWANDA UNION FREE SCHOOL DISTRICT